



# 4 Maitland Court, St Helier

St. Helier

# £445,000

Set in a rural location you will find this lovely granite two bedroom first floor apartment which offers a tranquil retreat just a short drive from the town centre. The property offers a spacious lounge/diner, separate kitchen, 2 double bedrooms, bathroom and guest WC. Take a leisurely stroll down leafy lanes or relax in the communal gardens and pool. This home is waiting for your personal touch, offering a great opportunity for those who enjoy a bit of DIY. With parking for 2 cars, convenience meets charm in this lovely abode.

Telephone: 01534 730 341

Email: [sales@gaudin.je](mailto:sales@gaudin.je)

22 Hill Street St Helier, Jersey JE2 4UA, Channel Islands



# Gallery



Telephone: 01534 730 341  
Email: sales@gaudin.je  
22 Hill Street St Helier, Jersey JE2 4UA, Channel Islands



# Property Details

**Location:** 4 Maitland Court, St Helier

Set in a rural location you will find this lovely granite two bedroom first floor apartment which offers a tranquil retreat just a short drive from the town centre. The property offers a spacious lounge/diner, separate kitchen, 2 double bedrooms, bathroom and guest WC. Take a leisurely stroll down leafy lanes or relax in the communal gardens and pool. This home is waiting for your personal touch, offering a great opportunity for those who enjoy a bit of DIY. With parking for 2 cars, convenience meets charm in this lovely abode.

**Telephone:** 01534 730 341

**Email:** [sales@gaudin.je](mailto:sales@gaudin.je)

22 Hill Street St Helier, Jersey JE2 4UA, Channel Islands

# Key Features

For Sale	Beds: 2	Baths: 1
Type: Apartment	Area: 775 ft <sup>2</sup>	2 bedrooms, 1 bathroom and WC
Large lounge/diner	Communal gardens & pool	Rural St Helier - 5 minute drive to town
Parking for 2 cars	Leafy lane walks	In need of some TLC

Telephone: 01534 730 341

Email: [sales@gaudin.je](mailto:sales@gaudin.je)

22 Hill Street St Helier, Jersey JE2 4UA, Channel Islands

# Floor Plans

FIRST FLOOR  
72.3 sq.m. (778 sq.ft.) approx.

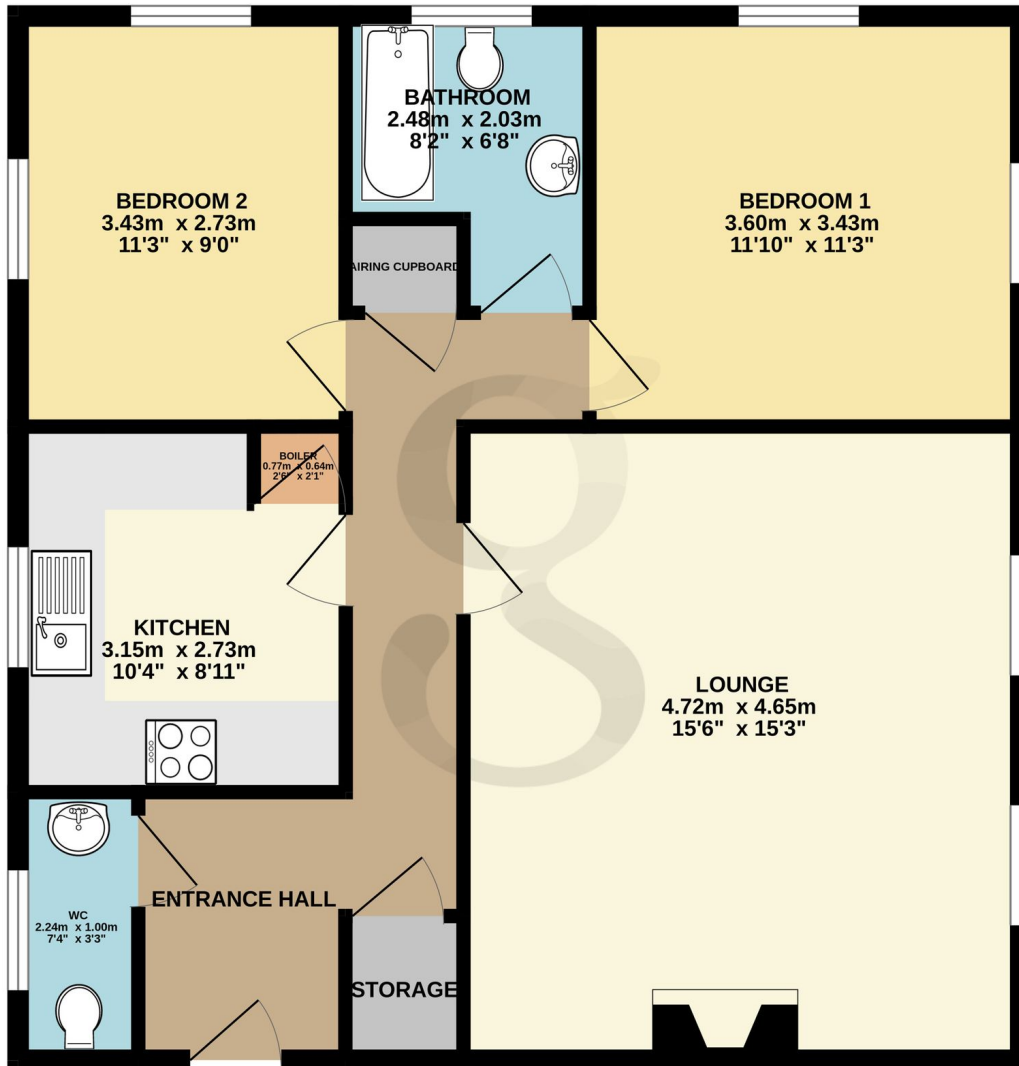

TOTAL FLOOR AREA : 72.3 sq.m. (778 sq.ft.) approx.

Whilst every attempt has been made to ensure the accuracy of the floorplan contained here, measurements of doors, windows, rooms and any other items are approximate and no responsibility is taken for any error, omission or mis-statement. This plan is for illustrative purposes only and should be used as such by any prospective purchaser. The services, systems and appliances shown have not been tested and no guarantee as to their operability or efficiency can be given.  
Made with Metropix ©2024

Telephone: 01534 730 341

Email: [sales@gaudin.je](mailto:sales@gaudin.je)

22 Hill Street St Helier, Jersey JE2 4UA, Channel Islands