



Le Jardin Potager, St Martin

St. Martin

£725,000

Tucked away in a serene setting, this detached country cottage offers a peaceful retreat from the hustle and bustle of every-day life. Entering the property, you're greeted by a spacious open plan kitchen/diner/lounge area, perfect for entertaining guests or simply relaxing with your loved ones. The cottage features 2 double bedrooms and 2 bathrooms, awaiting your personal touch for modernisation. A separate utility room adds to the convenience of living in this charming abode, allowing for practical tasks to be completed with ease. Stepping outside, the country cottage garden beckons you to unwind amidst its tranquil surroundings and admire the picturesque field views that stretch out before you. With ample parking for approximately 3 cars, you can easily accommodate visiting friends and...

Telephone: 01534 730 341

Email: sales@gaudin.je

22 Hill Street St Helier, Jersey JE2 4UA, Channel Islands

 **GAUDIN CO**
The Property People since 1934

Gallery



Property Details

Location: Le Jardin Potager, St Martin

Tucked away in a serene setting, this detached country cottage offers a peaceful retreat from the hustle and bustle of every-day life. Entering the property, you're greeted by a spacious open plan kitchen/diner/lounge area, perfect for entertaining guests or simply relaxing with your loved ones. The cottage features 2 double bedrooms and 2 bathrooms, awaiting your personal touch for modernisation. A separate utility room adds to the convenience of living in this charming abode, allowing for practical tasks to be completed with ease.

Stepping outside, the country cottage garden beckons you to unwind amidst its tranquil surroundings and admire the picturesque field views that stretch out before you. With ample parking for approximately 3 cars, you can easily accommodate visiting friends and family, ensuring that everyone can revel in the beauty of this rural location. If you've been dreaming of a slower pace of life in a peaceful countryside setting, this charming cottage offers the perfect opportunity to make those dreams a reality.

Telephone: 01534 730 341

Email: sales@gaudin.je

22 Hill Street St Helier, Jersey JE2 4UA, Channel Islands

Key Features

For Sale	Beds: 2	Baths: 2
Area: 1195 ft ²	Detached country cottage	In need of modernisation
Large open plan kitchen/diner/lounge	2 double bedrooms and 2 bathrooms	Separate utility room
Situated in a lovely rural location	Country cottage garden	Parking for circa 3 cars
Original building was converted in 2008		

Telephone: 01534 730 341

Email: sales@gaudin.je

22 Hill Street St Helier, Jersey JE2 4UA, Channel Islands

Floor Plans

GROUND FLOOR
60.0 sq.m. (646 sq.ft.) approx.

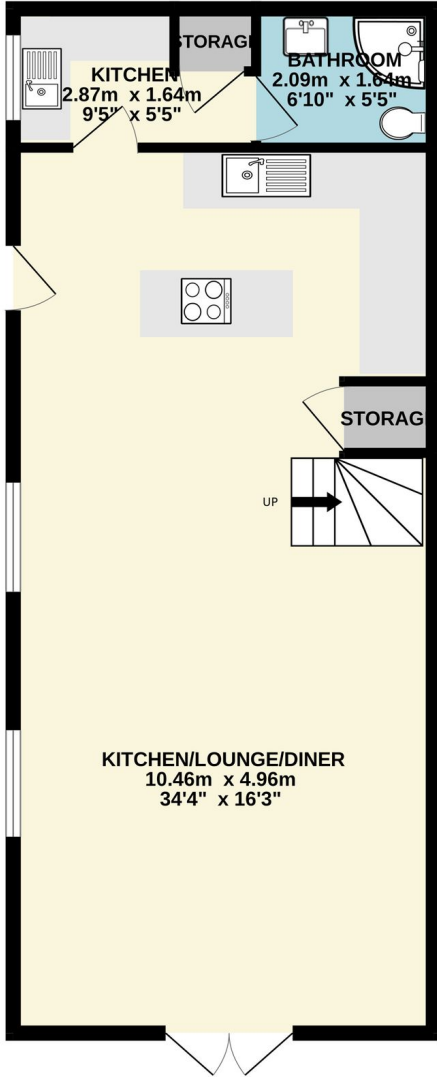

1ST FLOOR
51.7 sq.m. (556 sq.ft.) approx.

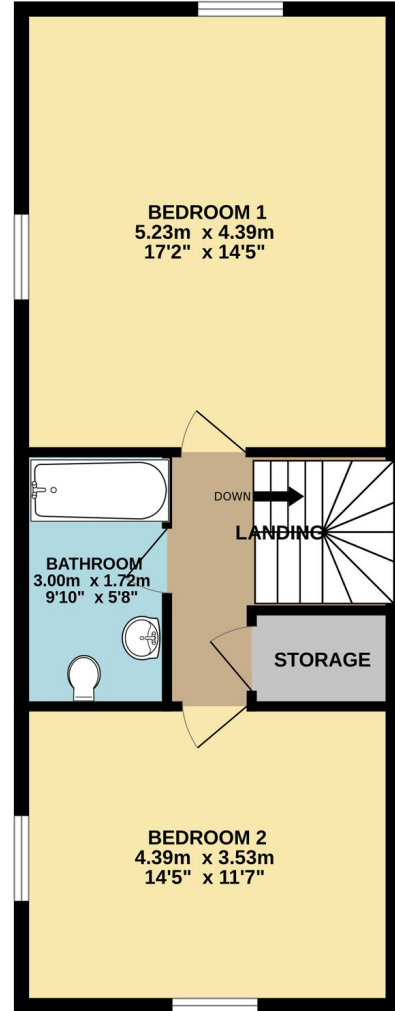

TOTAL FLOOR AREA : 111.7 sq.m. (1203 sq.ft.) approx.

Whilst every attempt has been made to ensure the accuracy of the floorplan contained here, measurements of doors, windows, rooms and any other items are approximate and no responsibility is taken for any error, omission or mis-statement. This plan is for illustrative purposes only and should be used as such by any prospective purchaser. The services, systems and appliances shown have not been tested and no guarantee as to their operability or efficiency can be given.
Made with Metropix ©2024

Telephone: 01534 730 341

Email: sales@gaudin.je

22 Hill Street St Helier, Jersey JE2 4UA, Channel Islands