

70 Roseville Street, St Helier

St. Helier

£650,000

Introducing this charming Victorian residence, nestled just a stone's throw away from the beach at Harve Des Pas. Boasting two generously-sized double bedrooms and two bathrooms, this home is sure to cater to your every need. The spacious kitchen/diner provides the perfect setting for entertaining, while the inviting lounge with a feature fireplace exudes warmth and character. Convenience is key with the inclusion of a separate guest WC and a designated parking space for one car. Lovingly maintained, this property is ideal for those seeking a coastal retreat or want to be able to walk to work. With its good location offering easy access to the beach, residents can enjoy leisurely strolls along the shoreline. To book a viewing please call 01534 670333 or email sales@gaudin.je

Telephone: 01534 730 341

Email: sales@gaudin.je

22 Hill Street St Helier, Jersey JE2 4UA, Channel Islands



Gallery



Property Details

Location: 70 Roseville Street, St Helier

Introducing this charming Victorian residence, nestled just a stone's throw away from the beach at Harve Des Pas. Boasting two generously-sized double bedrooms and two bathrooms, this home is sure to cater to your every need. The spacious kitchen/diner provides the perfect setting for entertaining, while the inviting lounge with a feature fireplace exudes warmth and character. Convenience is key with the inclusion of a separate guest WC and a designated parking space for one car.

Lovingly maintained, this property is ideal for those seeking a coastal retreat or want to be able to walk to work. With its good location offering easy access to the beach, residents can enjoy leisurely strolls along the shoreline.

To book a viewing please call 01534 670333 or email sales@gaudin.je

Telephone: 01534 730 341

Email: sales@gaudin.je

22 Hill Street St Helier, Jersey JE2 4UA, Channel Islands

Key Features

For Sale	Beds: 2	Baths: 2
Area: 829 ft ²	Lovely Victorian home	2 double bedrooms, 2 bathrooms
Spacious kitchen / diner	Lounge with feature fireplace	Separate guest WC
Very short walk to the beach	Parking for 1 car	

Telephone: 01534 730 341

Email: sales@gaudin.je

22 Hill Street St Helier, Jersey JE2 4UA, Channel Islands

Floor Plans

GROUND FLOOR
38.0 sq.m. (409 sq.ft.) approx.

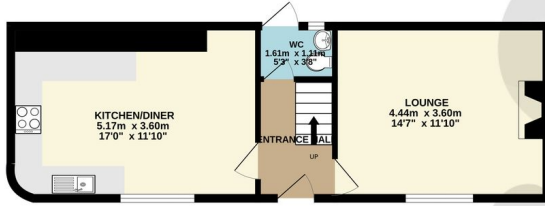

1ST FLOOR
39.4 sq.m. (424 sq.ft.) approx.



TOTAL FLOOR AREA: 77.3 sq.m. (832 sq.ft.) approx.

Whilst every attempt has been made to ensure the accuracy of the floorplan contained here, measurements of doors, windows, rooms and any other items are approximate and no responsibility is taken for any error, omission or mis-statement. This plan is for illustrative purposes only and should be used as such by any prospective purchaser. The services, systems and appliances shown have not been tested and no guarantee as to their operability or efficiency can be given.
Made with Metropix ©2024

Telephone: 01534 730 341

Email: sales@gaudin.je

22 Hill Street St Helier, Jersey JE2 4UA, Channel Islands