



# Duhamel Cottage, St Helier

St. Helier

# £1,700 pcm

Licensed or Entitled : This centrally located cottage is tucked away behind a gated entrance and has the added benefit of its own patio garden. The accommodation comprises a fitted kitchen, living room, two double bedrooms, bathroom and good size loft space. Regret no parking. No pets.

Telephone: 01534 730 341

Email: [sales@gaudin.je](mailto:sales@gaudin.je)

22 Hill Street St Helier, Jersey JE2 4UA, Channel Islands

 **GAUDIN CO**  
*The Property People since 1934*

# Gallery



# Property Details

**Location:** Duhamel Cottage, St Helier

Licensed or Entitled : This centrally located cottage is tucked away behind a gated entrance and has the added benefit of its own patio garden. The accommodation comprises a fitted kitchen, living room, two double bedrooms, bathroom and good size loft space. Regret no parking. No pets.

**Telephone:** 01534 730 341

**Email:** [sales@gaudin.je](mailto:sales@gaudin.je)

22 Hill Street St Helier, Jersey JE2 4UA, Channel Islands

# Key Features

For Rent

Beds: 2

Baths: 1

2 bedrooms, 1 bathroom

Situated within walking distance of town centre

Rear terraced garden area

Telephone: 01534 730 341

Email: [sales@gaudin.je](mailto:sales@gaudin.je)

22 Hill Street St Helier, Jersey JE2 4UA, Channel Islands

# Floor Plans

GROUND FLOOR  
279 sq.ft. (25.9 sq.m.) approx.

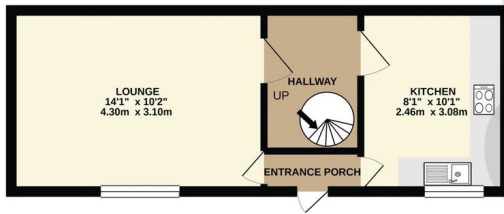

1ST FLOOR  
291 sq.ft. (27.0 sq.m.) approx.

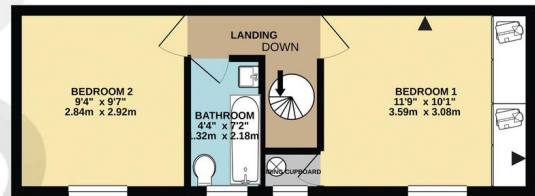

TOTAL FLOOR AREA: 569 sq.ft. (52.9 sq.m.) approx.

Whilst every attempt has been made to ensure the accuracy of the floorplan contained here, measurements of doors, windows, rooms and any other items are approximate and no responsibility is taken for any error, omission or mis-statement. This plan is for illustrative purposes only and should be used as such by any prospective purchaser. The services, systems and appliances shown have not been tested and no guarantee as to their operability or efficiency can be given.  
Made with Metropix ©2021

Telephone: 01534 730 341

Email: [sales@gaudin.je](mailto:sales@gaudin.je)

22 Hill Street St Helier, Jersey JE2 4UA, Channel Islands