



Fauvic Court, Grouville

Grouville

£469,000

This duplex apartment, situated near the beach, offers a tranquil retreat away from the hustle and bustle of town. With two bedrooms, a sunny lounge / diner, and a separate kitchen, it provides a comfortable living space. . The inclusion of a garage and parking adds practicality to the property. Private beach access is undoubtedly a coveted feature, ideal for enjoying leisurely strolls or relaxing by the sea. Its proximity to Gorey Harbour and convenient access to public transportation make it an attractive option for those seeking both convenience and tranquility. Overall, this property presents a unique opportunity not to be overlooked!

Telephone: 01534 730 341

Email: sales@gaudin.je

22 Hill Street St Helier, Jersey JE2 4UA, Channel Islands



Gallery



Telephone: 01534 730 341
Email: sales@gaudin.je
22 Hill Street St Helier, Jersey JE2 4UA, Channel Islands



Property Details

Location: Fauvic Court, Grouville

This duplex apartment, situated near the beach, offers a tranquil retreat away from the hustle and bustle of town. With two bedrooms, a sunny lounge / diner, and a separate kitchen, it provides a comfortable living space. . The inclusion of a garage and parking adds practicality to the property. Private beach access is undoubtedly a coveted feature, ideal for enjoying leisurely strolls or relaxing by the sea. Its proximity to Gorey Harbour and convenient access to public transportation make it an attractive option for those seeking both convenience and tranquility. Overall, this property presents a unique opportunity not to be overlooked!

Telephone: 01534 730 341

Email: sales@gaudin.je

22 Hill Street St Helier, Jersey JE2 4UA, Channel Islands

Key Features

For Sale	Beds: 2	Baths: 1
Type: Apartment	Area: 689 ft ²	2 bedrooms, 1 bathroom
Separate kitchen	Lovely light lounge / diner	Garage plus parking
Great apartment near the sea	Private beach access	On a great bus route to Gorey or town
Immaculately presented	SHARE TRANSFER	No forward chain

Telephone: 01534 730 341

Email: sales@gaudin.je

22 Hill Street St Helier, Jersey JE2 4UA, Channel Islands

Floor Plans

GROUND FLOOR
32.2 sq.m. (346 sq.ft.) approx.

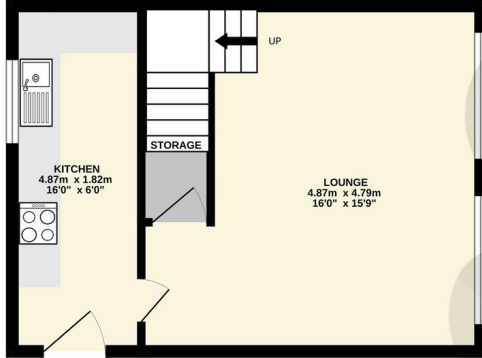

1ST FLOOR
32.2 sq.m. (346 sq.ft.) approx.

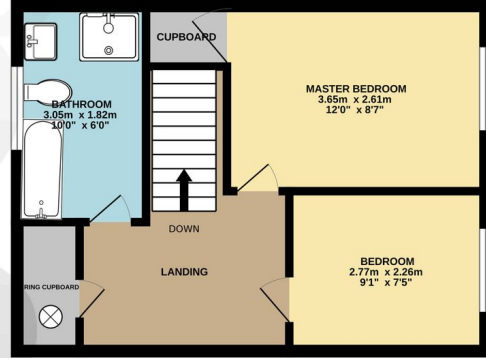

TOTAL FLOOR AREA : 64.4 sq.m. (693 sq.ft.) approx.

Whilst every attempt has been made to ensure the accuracy of the floorplan contained here, measurements of doors, windows, rooms and any other items are approximate and no responsibility is taken for any error, omission or mis-statement. This plan is for illustrative purposes only and should be used as such by any prospective purchaser. The services, systems and appliances shown have not been tested and no guarantee as to their operability or efficiency can be given.
Made with Metropix 6/2024.

Telephone: 01534 730 341

Email: sales@gaudin.je

22 Hill Street St Helier, Jersey JE2 4UA, Channel Islands