



19 Don Street, St Helier

St. Helier

£649,000

An exciting opportunity to acquire a multi use Investment property in the centre of St Helier. Ground floor is currently occupied by a very well established and successful framing business (Lease expires 2026) Upper floor provides an excellent sized duplex apartment providing two bedrooms, a living space and a separate kitchen. Whilst in need of cosmetic improvements, the apartment provides excellent space. For further enquiries or to arrange a viewing, please contact Adam Lescop - adaml@gaudin.je or 07797 761026

Telephone: 01534 730 341

Email: sales@gaudin.je

22 Hill Street St Helier, Jersey JE2 4UA, Channel Islands



Gallery



Property Details

Location: 19 Don Street, St Helier

An exciting opportunity to acquire a multi use Investment property in the centre of St Helier. Ground floor is currently occupied by a very well established and successful framing business (Lease expires 2026) Upper floor provides an excellent sized duplex apartment providing two bedrooms, a living space and a separate kitchen. Whilst in need of cosmetic improvements, the apartment provides excellent space. For further enquiries or to arrange a viewing, please contact Adam Lescop - adaml@gaudin.je or 07797 761026

Telephone: 01534 730 341

Email: sales@gaudin.je

22 Hill Street St Helier, Jersey JE2 4UA, Channel Islands

Key Features

For Sale	Investment opportunity	Commercial unit on the ground floor
Duplex apartment on the upper floors	Apartment requires cosmetic improvements	Established commercial tenant
Great central location	Gross yield over 8% per annum	Circa 2560 sq ft
Vendors Sole Agent		

Telephone: 01534 730 341

Email: sales@gaudin.je

22 Hill Street St Helier, Jersey JE2 4UA, Channel Islands

Floor Plans

GROUND FLOOR
136.1 sq.m. (1465 sq.ft.) approx.

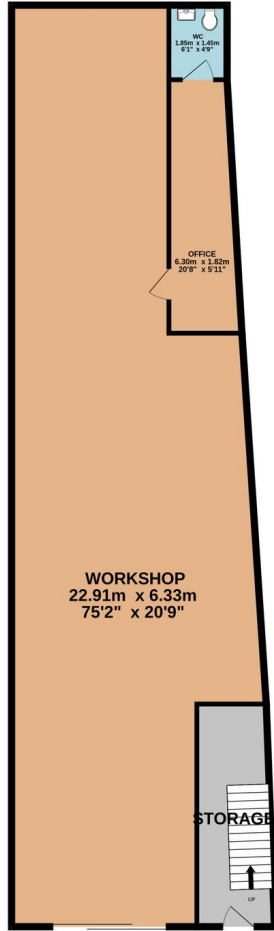

1ST FLOOR
53.0 sq.m. (570 sq.ft.) approx.



2ND FLOOR
48.4 sq.m. (521 sq.ft.) approx.

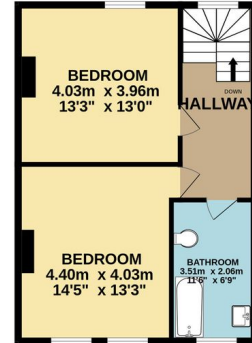

TOTAL FLOOR AREA : 237.5 sq.m. (2556 sq.ft.) approx.

Whilst every attempt has been made to ensure the accuracy of the floorplan contained here, measurements of doors, windows, rooms and any other items are approximate and no responsibility is taken for any error, omission or mis-statement. This plan is for illustrative purposes only and should be used as such by any prospective purchaser. The services, systems and appliances shown have not been tested and no guarantee as to their operability or efficiency can be given.
Made with Metropix ©2024

Telephone: 01534 730 341

Email: sales@gaudin.je

22 Hill Street St Helier, Jersey JE2 4UA, Channel Islands