

## Cliffside House, St Helier

St. Helier

# £615,000

This 3 bedroom house on the outskirts of town set over 3 floors, has been refurbished throughout and enjoys wide reaching views over St Helier to St Aubin's and St Clements Bays in the distance. The property is very light and offers spacious versatile accommodation throughout. The property comprises of, a bright and spacious living room with views over the town, a fitted kitchen, house bathroom, separate shower room, bedroom 3 / office / playroom and a good size attic room make up the first floor and two double bedrooms with a master en-suite make up the first floor. To the rear there is a decked area directly from the house with steps leading to a further terraced cotil garden with stunning views.

Telephone: 01534 730 341

Email: [sales@gaudin.je](mailto:sales@gaudin.je)

22 Hill Street St Helier, Jersey JE2 4UA, Channel Islands



# Gallery



# Property Details

**Location:** Cliffside House, St Helier

This 3 bedroom house on the outskirts of town set over 3 floors, has been refurbished throughout and enjoys wide reaching views over St Helier to St Aubin's and St Clements Bays in the distance. The property is very light and offers spacious versatile accommodation throughout. The property comprises of, a bright and spacious living room with views over the town, a fitted kitchen, house bathroom, separate shower room, bedroom 3 / office / playroom and a good size attic room make up the first floor and two double bedrooms with a master en-suite make up the first floor. To the rear there is a decked area directly from the house with steps leading to a further terraced cotil garden with stunning views.

**Telephone:** 01534 730 341

**Email:** [sales@gaudin.je](mailto:sales@gaudin.je)

22 Hill Street St Helier, Jersey JE2 4UA, Channel Islands

# Key Features

For Sale	Beds: 3	Baths: 3
Area: 1561 ft <sup>2</sup>	3 bedrooms, 3 bathrooms	Renovated throughout
All bedrooms are doubled	Lovely and light	Spacious accommodation
Short stroll to town	Rear cotil garden plus patio area	Approx 1570 sq foot

Telephone: 01534 730 341

Email: [sales@gaudin.je](mailto:sales@gaudin.je)

22 Hill Street St Helier, Jersey JE2 4UA, Channel Islands

# Floor Plans

GROUND FLOOR  
7.4 sq.m. (80 sq.ft.) approx.



1ST FLOOR  
82.7 sq.m. (890 sq.ft.) approx.



2ND FLOOR  
44.9 sq.m. (483 sq.ft.) approx.

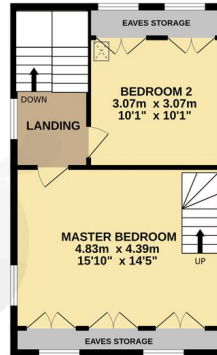

3RD FLOOR  
10.8 sq.m. (117 sq.ft.) approx.

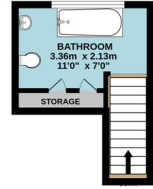

TOTAL FLOOR AREA: 145.8 sq.m. (1570 sq.ft.) approx.

Whilst every attempt has been made to ensure the accuracy of the floorplan contained here, measurements of doors, windows, rooms and any other items are approximate and no responsibility is taken for any error, omission or mis-statement. This plan is for illustrative purposes only and should be used as such by any prospective purchaser. The services, systems and appliances shown have not been tested and no guarantee as to their operability or efficiency can be given.

Made with Metropix ©2024

Telephone: 01534 730 341

Email: [sales@gaudin.je](mailto:sales@gaudin.je)

22 Hill Street St Helier, Jersey JE2 4UA, Channel Islands